



UNIVERSAL DRINK HOLDER

1464

WITH STAINLESS CUP

FITS: UNIVERSAL FOR 1" HANDLEBARS, INTENDED TO HOLD INCLUDED STAINLESS STEEL MUG

PARTS INCLUDED

- 1 Stainless Steel Cup
1 Handlebar Clamp/Drink Holder Ring Assembly
1 Anti-Seize Packet
1 Hardware Kit
2 Shims
1 Thumb Nut
1 5/16" Split Lock Washer
1 Installation Instructions

Please read and understand entire instructions before starting installation.

THANK YOU FOR CHOOSING KURYAKYN!

IN ORDER TO PROTECT YOU AND OTHERS FROM POSSIBLE INJURY AND/OR PROPERTY DAMAGE OR LOSS, PLEASE PAY CLOSE ATTENTION TO ALL INSTRUCTIONS, WARNINGS, CAUTIONS AND ATTENTION NOTES REGARDING THE USE AND CARE OF THIS PRODUCT.

WARNING! THIS INDICATION ALERTS YOU TO THE FACT THAT IGNORING THE CONTENTS DESCRIBED HEREIN CAN RESULT IN POTENTIAL DEATH OR SERIOUS INJURY.

CAUTION! This indication alerts you to the fact that ignoring the contents described herein can result in potential injury or material damage.

ATTENTION! This indication alerts you to the fact that ignoring the contents described herein may negatively affect product performance and functionality.

TOOLS SUGGESTED

Set of Hex Wrenches

STRICTLY OBSERVE THE FOLLOWING GUIDELINES IN ORDER TO USE THE PRODUCT PROPERLY AND AVOID POTENTIALLY DANGEROUS ACCIDENTS.

PROCEDURE - Please note that all hardware included may not be used for installation

STEP 1 Read and understand all steps in the instructions before starting the installation. Park the motorcycle on a hard, level surface; turn off the ignition and allow the engine to cool.

STEP 2 Place a clean, soft blanket over the gas tank to protect the paint.

CAUTION! Avoid damage to the motorcycle. Protect painted surfaces with a soft cloth or blanket.

STEP 3 Determine a suitable mounting location for the Drink Holder, ensuring that the mounting location will not interfere with the normal operation of the motorcycle.

NOTE: The clamp may be fit with the pivot hole above or below the handlebar depending on clearance.



CUSTOMER SERVICE
877.370.3604 (toll free)

INSTALLATION QUESTIONS
techsupport@kuryakyn.com
or call 715.247.2983

LIMITED WARRANTY

Kuryakyn warrants that any Kuryakyn products sold hereunder, shall be free of defects in materials and workmanship for a period of one (1) year from the date of purchase by the consumer...

- Kuryakyn shall have no obligation in the event the customer is unable to provide a receipt showing the date the customer purchased the product(s).
• The product must be properly installed, maintained and operated under normal conditions.
• Kuryakyn makes no warranty, expressed or implied, with respect to any gold plated products.
• Kuryakyn shall not be liable for any consequential and incidental damages, including labor and paint, resulting from failure of a Kuryakyn product, failure to deliver, delay in delivery, delivery in nonconforming condition, or for any breach of contract or duty between Kuryakyn and a customer.
• Kuryakyn products are often intended for use in specific applications. Kuryakyn makes no warranty if a Kuryakyn product is used in applications other than intended.
• Kuryakyn electrical products are warranted for one (1) year from the date of purchase by the consumer. Components of Kuryakyn products containing L.E.D.s will be warranted for defects in materials and workmanship for 3 years from the date of purchase.
• Kuryakyn makes no warranty of any kind in regard to other manufacturer's products distributed by Kuryakyn. Kuryakyn will pass on all warranties made by the manufacturer and where possible, will expedite the claim on behalf of the customer, but ultimately, responsibility for disposition of the warranty claim lies with the manufacturer.

ABOUT OUR CATALOG

You'll find all our innovations for H-D, GL and Metric Cruisers in our annual catalogs. Order online today-select the "CATALOGS" icon. Each Kuryakyn® product comes with a Proof-of-Purchase good for a complimentary catalog. Details in packaging.

Be sure to ask your local dealer about other Kuryakyn® products, the motorcycle parts and accessories designed for riders by riders.

©2005 Kuryakyn USA® All Rights reserved.



**STEP 4** Remove the two screws in the handlebar clamp.

**STEP 5** Hold the clamp halves together on the handlebars in the desired location. Re-install the screws removed in STEP 4 after adding anti-seize to the threads, only finger tightening them for now.

**STEP 6** Place the included cup in the drink holder, turn the handlebars in both directions to their full stop position and ensure that there is clearance between the drink holder/cup and the gas tank, dash and other accessories.

**WARNING!** ENSURE THAT THERE IS CLEARANCE AT ALL POINTS WHEN THE HANDLEBARS ARE TURNED, INSUFFICIENT CLEARANCE MAY CAUSE DAMAGE TO THE MOTORCYCLE OR CAN CAUSE LOSS OF CONTROL THAT COULD RESULT IN SEVERE INJURY OR DEATH.

**ATTENTION!** Determine the mounting location and orientation of the Drink Holder before fully tightening the two screws. The clamp may leave marks on the handlebar when tightened down.

**STEP 7** Adjust the drink holder and clamp as necessary to achieve sufficient clearance.

**STEP 8** Tighten the two screws in the handlebar clamp.

**CAUTION!** Ensure that the installation of this product does not interfere with the proper operation of the motorcycle before riding.

**STEP 9** Place the drink holder stud through the handlebar clamp pivot hole.

**STEP 10** As shown in PIC 1, place the 5/16" split lock washer on the threaded end of the stud. Add anti-seize to the threads and secure with the thumbnut.

**ATTENTION!** It is the installer's responsibility to ensure that all of the fasteners (including pre-assembled) are tightened before operation of the motorcycle. Kuryakyn will not warranty components lost due to improper installation. Periodic maintenance may be required.

**CAUTION!** Kuryakyn is not responsible for items that may be stolen or damaged in relation to the use of this product.

**CAUTION!** The adjustability of the Drink Holder was not intended to prevent spills.

*Ride On!*

**Kuryakyn**<sup>®</sup>

PIC. 1

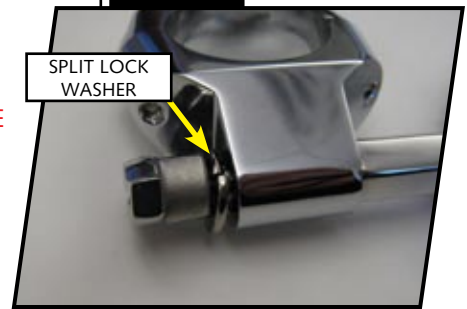

**PAGE**

**2**

**DRINK HOLDER**

**INSTALLATION**